

**Howard Road, New Malden, KT3 4DW**

**£900,000 Freehold**









## Howard Road, New Malden, KT3 4DW.

A true rare opportunity to acquire an unadulterated Edwardian home, offering great potential in the heart of New Malden.

Parry and Drewett are proudly instructed to bring this 4 Bedroom period property to the market. Occupying an enviable position at the foot of the Malden Hill of the town with simple access of New Malden's comprehensive amenities; Malden Centre, Beverly Park, High Street, Mainline station to not only London Waterloo (25 Mins) but Surbiton and Twickenham.



This house offers the foundation for a family home which can be tailored to suit the specific needs and wants of those prepared to meet the challenge and appreciate such yet untapped opportunity. The property we feel is realistically priced accordingly.

Whilst viewing will be arranged in accordance with current government COVID 19 guidelines we anticipate strong demand so do not hesitate to contact our office to seek an appointment.  
0208 949 0955.

EPC Rating: G



**Ground Floor**

Approx. 80.6 sq. metres (867.9 sq. feet)

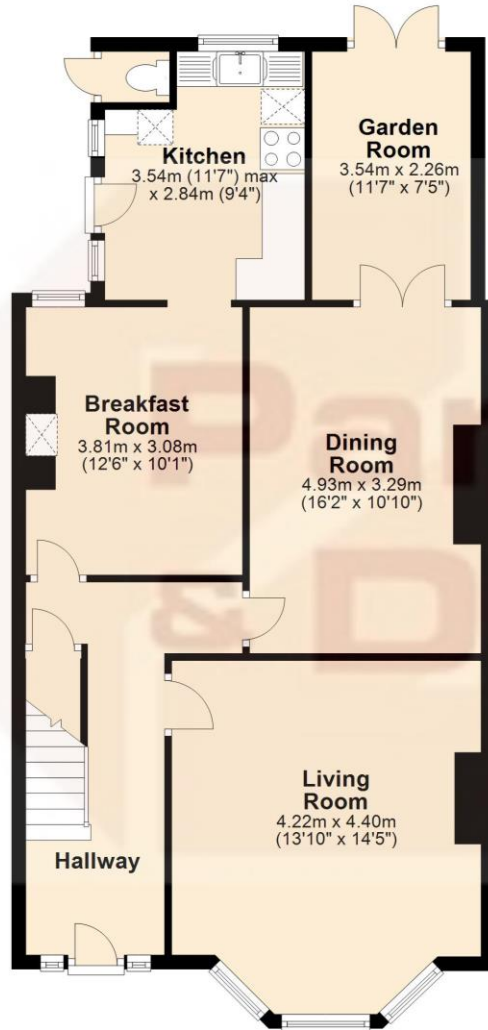

**First Floor**

Approx. 72.8 sq. metres (784.0 sq. feet)



Total area: approx. 153.5 sq. metres (1651.9 sq. feet)

Whilst every effort is taken to ensure the accuracy of these details the floor plan should only be viewed as indicative and any sizes are not exact  
Plan produced using PlanUp.

