

A Bit about Islington
Borough: Islington
County: Greater London

The London Borough of Islington was formed in 1965 by merging the former metropolitan boroughs of Islington and Finsbury. **Attractions include:** Almeida Theatre, Business Design Centre, Emirates Stadium, House of Detention museum, Estorick Collection of Modern Italian Art, Islington Local History Centre, Islington Museum, The King's Head Theatre and London Canal Museum. Street markets to visit include Camden Passage, Chapel Market, Exmouth Market, Nag's Head Market and Whitecross Street Market.

Parks and open spaces: Barnard Park, Bingfield Park, Bunhill Fields, Caledonian Park, Gillespie Park, Highbury Fields, Paradise Park, Rosemary Gardens, Spa Fields Gardens and Whittington Park.

Transport - Islington has a wide variety of transportation services, with direct connections to the suburbs and the City and West End. Islington also has 10 tube stations within its boundaries, with connections by the tube to all around London. These stations principally serve the Northern, Piccadilly and Victoria lines. Farringdon station is also served by the Circle, Hammersmith & City and Metropolitan lines. Tube and rail station: Angel, Archway, Arsenal, Caledonian Road, Canonbury railway station, Crouch Hill railway station, Drayton Park railway station, Essex Road railway station, Farringdon, Finsbury Park station, Highbury and Islington, Holloway Road, Old Street, Tufnell Park, Upper Holloway railway station. **London Overground stations:** Caledonian Road & Barnsbury, Canonbury, Crouch Hill, Highbury & Islington, Upper Holloway. There are several railway stations in the borough. Drayton Park, Essex Road, Farringdon, Finsbury Park, Highbury and Islington, Old Street.

Universities: City University, London at Northampton Square, formerly the Northampton Institute, founded in 1894; and London Metropolitan University, North Campus on the Holloway Road, formed from the merger of the University of North London and London Guildhall University in 2002. **Colleges** - City and Islington College; and Westminster Kingsway College. The Musical Theatre Academy is a private performing arts college located in Islington. **Schools:** The borough currently maintains 47 primary schools, 10 secondary schools, three special school. In 2000, Cambridge Education Associates, a private firm, took over the management of the Islington's state schools from the local education authority.

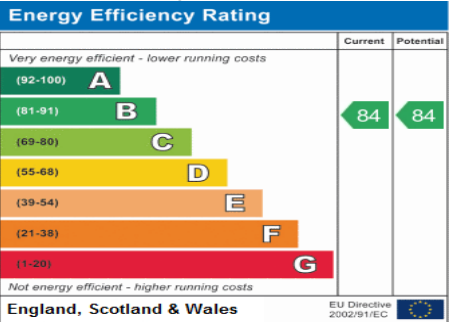

Address:
Hanley Road, N4



Part- Furnished. Available 'Soon'.

A delightful, one bedroom, ground floor conversion set within a beautifully maintained and well-presented, three-storey Victorian residence. Further comprising open-planned kitchen/reception and bathroom. Conveniently positioned within a moments walk of the array of enviable amenities on Stroud Green Road with Finsbury Park station within a short walk.

**Hanley Road
N4**

**Monthly Rental Of
£1,213.33**

Fees

Reference Fee: £85 Incl VAT per person
Guarantor Reference Fee: £85 Incl VAT if required
Admin Fee: £100 Incl VAT per property
Renewal Fee: £95 Incl VAT
Reference Request: £35 Incl VAT

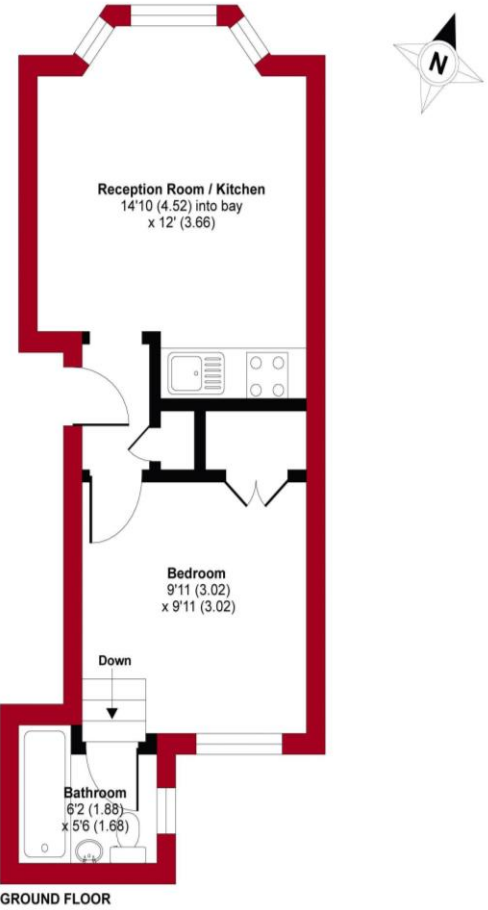

APPROX. GROSS INTERNAL FLOOR AREA 327 SQ FT 30.4 SQ METRES

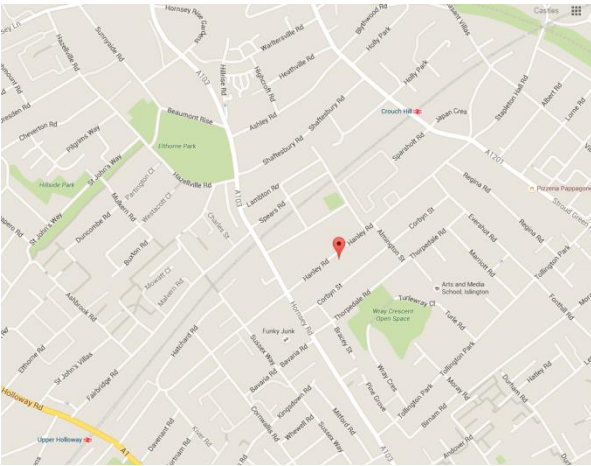

All details including floor plans are for representative purposes only and do not constitute a contract or warranty. Whilst every effort is made to ensure accuracy of descriptions and measurements, no responsibility is taken for errors, omissions and misstatements.

view

