



Bringing to the market this stunning Two bedroom first floor maisonette. Situated to the west side of Colchester this home boasts a light and airy accommodation throughout. Comprising entrance hall, stairs leading to landing, spacious kitchen, newly decorated lounge, two double bedrooms and a family bathroom. To the outside of the property you will gain off-road parking and a large private enclosed rear garden. This home is perfect for both first time buyers alike with local schooling and amenities nearby.

Price Guide Price £190,000



- TWO DOUBLE BEDROOMS
- PRIVATE REAR GARDEN
- OFF ROAD PARKING
- WELL PRESENTED THROUGHOUT
- FOUR PIECE BATHROOM
- WEST SIDE OF COLCHESTER
-
-
-
-

GROUND FLOOR
350 sq ft (32.3 sq m) approx.

1ST FLOOR
688 sq ft (63.8 sq m) approx.

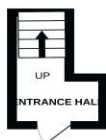

TEMME
ENGLISH



TOTAL FLOOR AREA: 723 sq ft (67.2 sq m) approx.
We warrant that the floor area is approximately as stated. We do not warrant the accuracy of the floor area measurements. The floor area measurements are for information only and do not constitute a guarantee. The floor area measurements are for information only and do not constitute a guarantee. The floor area measurements are for information only and do not constitute a guarantee.

