



Ashwood Court, Highgate Road, Forest Row, RH18

Guide Price £480,000-£500,000 Leasehold

**MANSELL
McTAGGART**
Trusted since 1947

in brief...

- SECOND FLOOR APARTMENT
- BUILT BY LOCAL DEVELOPERS
- WELL ARRANGED INTERIOR
- ADJACENT ASHDOWN FOREST
- SOUTH FACING LOCATION

- SEMI RURAL SETTING
- 2 DOUBLE BEDROOMS S BATHROOMS
- LOUNGE WITH HIGH CEILING
- STUDY KITCHEN UTILITY ROOM
- UNDERGROUND PARKING



in more detail...

A SECOND FLOOR APARTMENT AT ASHWOOD COURT which is located adjacent to the Ashdown Forest and the Royal Ashdown Golf Course. The apartments stand on the site of a former hotel and was re-developed by Rydon Homes in the early 2000's. Ashwood Court is a development of quality one and two bedroomed apartments arranged over three floors with gated underground parking. Access to the building is by entry telephone system to an outer vestibule, with postboxes, and through further security doors to the light inner reception hall. The apartment for sale is situated on the second floor and can be accessed via the stairs or lift. The front door of the flat opens in to a good sized hallway with storage cupboard, and glazed double doors to the south facing lounge with a large balcony and pleasant outlook to a lightly wooded section of the Forest. There are two good sized bedrooms, both with doors to the balcony, adjacent bathrooms, a dressing area with full height fitted wardrobe cupboards and a study. The kitchen has fitted cupboards, drawers, wall cupboards and worktops together with a double oven microwave, hob and hood. There is an adjacent utility room with space and plumbing for a washing machine, single drainer stainless steel sink unit, and built in cupboard housing the lagged hot tank and boiler. Being on the top floor there are high ceilings in some of the rooms. There are two allocated parking spaces in the underground car park.



outside and the location...

This apartment is ideally placed for those seeking a home close to open countryside yet within three quarters of a mile of the village centre. The Royal Ashdown Golf Course is located opposite the apartment together with the Ashdown Forest which has 6,400 acres of heath/woodland for riding (by permit) and walking.

The village has a number of local sports clubs including cricket, tennis, golf and football all within a few hundred yards of the flat.

Forest Row has a wide and varied range of specialist shops, local stores, galleries, cafes and restaurants. The town of East Grinstead is within four miles with its more extensive range of shops, leisure amenities and rail station to London.

There are a wide range of schools both private and state within the local area including a primary school, Rudolf Steiner Michael Hall School and Ashdown House School, all within the village itself.

DIRECTIONS: From our office proceed east along the Hartfield Road (B2110) and turn right into Chapel Lane (signposted Golf Club). Ashwood Court will be found at the very top opposite the Cricket Pitch.

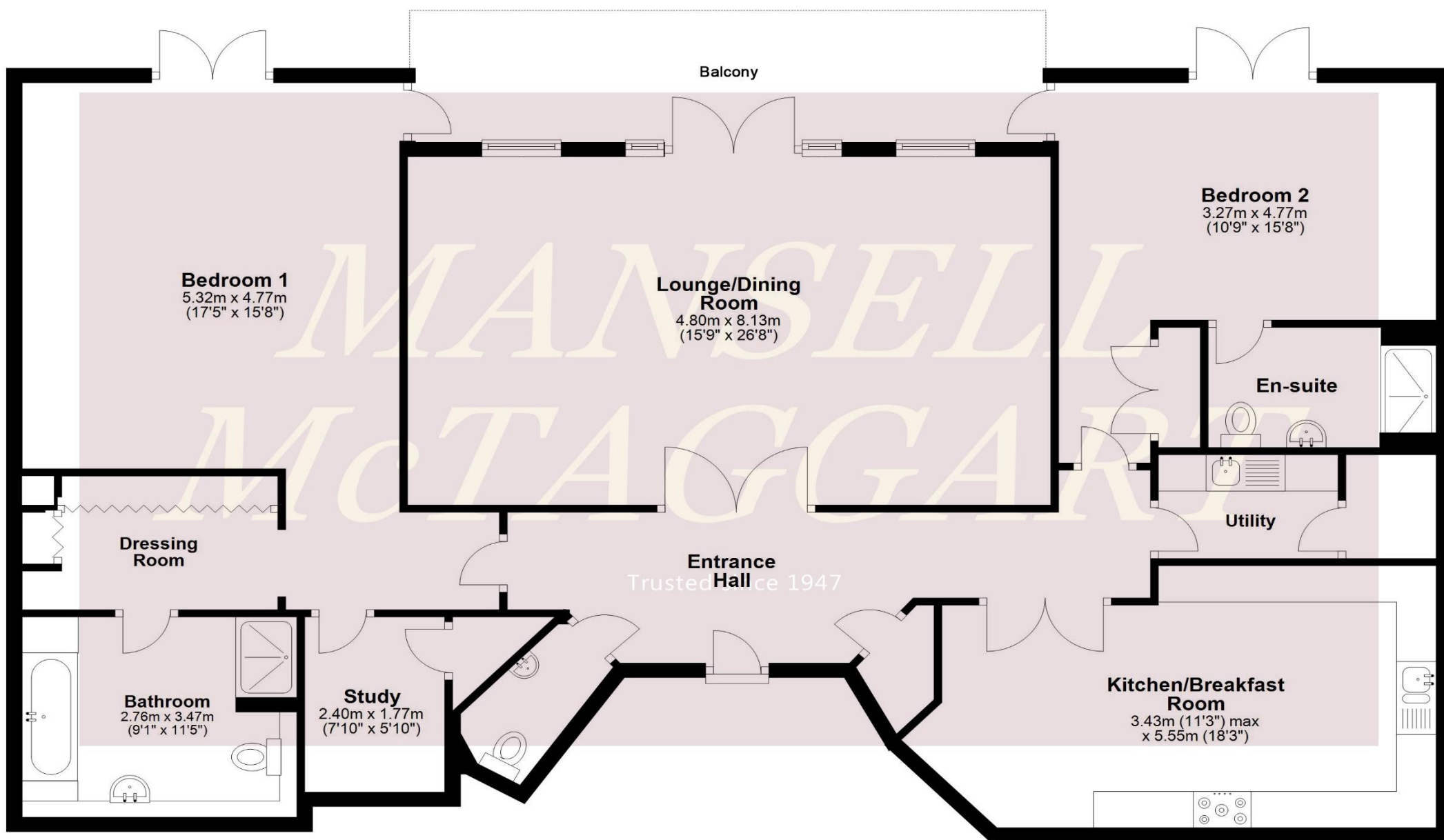

Total area: approx. 163.0 sq. metres (1754.1 sq. feet)

This floor-plan is Copyrighted and may only be used by Mansell McTaggart for commercial purposes.

**MANSELL
McTAGGART**
Trusted since 1947

call: Forest Row: 01342 826682
email: fr@mansellmctaggart.co.uk
web: www.mansellmctaggart.co.uk

Consumer Protection from Unfair Trading Regulations 2008 We have not tested any apparatus, equipment, fixtures, fittings or services and so cannot verify that they are in working order or fit for purpose. You are advised to obtain verification from your solicitor or surveyor. References to the tenure of a property are based on information supplied by the seller. We have not had sight of the title documents and a buyer is advised to obtain verification from their solicitor. Items shown in photographs are not included unless specifically mentioned within the sales particulars, but may be available by separate negotiation. We advise you to book an appointment to view before embarking on any journey to see a property, and check its availability.