



Stone Quarry Road, Chelwood Gate, RH17

£650,000 Freehold

**MANSELL
McTAGGART**
Trusted since 1947

in brief...

- DETACHED BUNGALOW
- EXCEPTIONALLY SPACIOUS
- ADAPTABLE FAMILY ACCOMMODATION
- VILLAGE LOCATION
- CLOSE TO ASHDOWN FOREST

- BETWEEN CHELWOOD GATE & DANEHILL
- 5 BEDROOMS 3 BATHROOMS
- LIVING ROOM STUDY
- KITCHEN BREAKFAST/DINING ROOM
- PARKING FOR 3 CARS LARGE GARDEN



in more detail...

SURPRISINGLY SPACIOUS PROPERTY OF ALMOST TWO THOUSAND SQUARE FEET located in the popular East Sussex village of Chelwood Gate. The property stands on an east facing plot

Within four hundred yards of Ashdown Forest . The larger villages of Nutley and Forest Row are only a short drive. Comprising a detached bungalow built externally of brick under a tiled roof with a later rear extension the front of the property belies the exceptionally spacious interior. Being arranged on one floor the interior has flexible family accommodation. Currently the layout comprises five bedrooms (two en suite) and three bath/shower rooms. The living room located at the rear extends to twenty four feet and opens out on to the terrace and garden. There is also a small study/dressing room. The kitchen has fitted work surfaces, cupboards and drawers together with wall cupboards, inset hob and sink unit. There is an adjacent breakfast/dining room and a large entrance hall and inner lobby. The forecourt provides off street hardstanding for three cars. To the rear of the property is a long west facing garden laid to lawn a broad wrap around terrace and with established borders. The total plot size is approx. 1/4 acre.

Council Tax Band

EPC Rating



outside and the location...

Chelwood Gate is a popular village, adjacent to the Ashdown Forest with its 6,400 acres of heath/woodland, and only four miles south of Forest Row. The nearest shops are in Nutley (2.5 miles) and a much broader selection of shops, cafes, galleries and restaurants in Forest Row. The towns of Haywards Heath and East Grinstead, offering a more extensive range of amenities, are both within eight miles with rail services to London. There are a wide selection of schools in the area including primary schools in Danehill, Forest Row and Nutley, Cumnor House closeby and a number of other state and private schools in the local vicinity. Places of interest nearby include the Bluebell Steam Railway running between Sheffield Park and East Grinstead, , Sheffield Park and Wakehurst Place Gardens, and Hever Castle near Edenbridge. There are a good number of respected hotels locally including Gravetye Manor, Ashdown Park & Alexander House. DIRECTIONS: From Forest Row proceed south on the A22, and bear right after the lights at Wych Cross onto the A275, opposite the Roebuck Hotel. Turn left after the Red Lion, Beaconsfield Road, and right after a mile into Stone Quarry Road. The house is a short distance on the right.

Ground Floor

Approx. 172.2 sq. metres (1853.7 sq. feet)

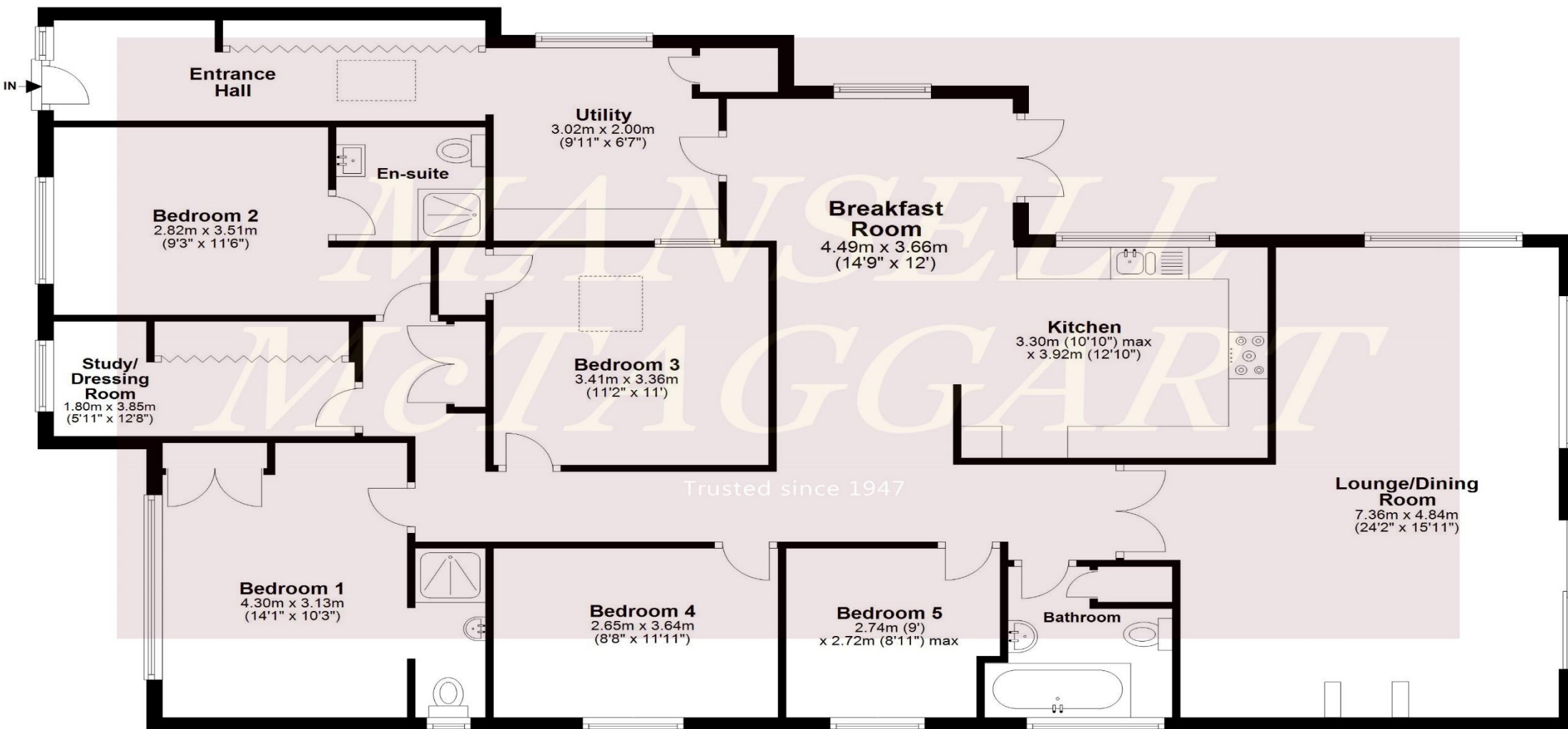

Total area: approx. 172.2 sq. metres (1853.7 sq. feet)

This floor-plan is Copyrighted and may only be used by Mansell McTaggart for commercial purposes.

**MANSELL
McTAGGART**
Trusted since 1947

call: Forest Row: 01342 826682
email: fr@mansellmctaggart.co.uk
web: www.mansellmctaggart.co.uk

Consumer Protection from Unfair Trading Regulations 2008 We have not tested any apparatus, equipment, fixtures, fittings or services and so cannot verify that they are in working order or fit for purpose. You are advised to obtain verification from your solicitor or surveyor. References to the tenure of a property are based on information supplied by the seller. We have not had sight of the title documents and a buyer is advised to obtain verification from their solicitor. Items shown in photographs are not included unless specifically mentioned within the sales particulars, but may be available by separate negotiation. We advise you to book an appointment to view before embarking on any journey to see a property, and check its availability.