

the floorplan...



0208 912 0006
brian-cox.co.uk



Brian Cox are very proud to bring to the market this three bedroom end of terraced Victorian house. This family home is laid out over two floors, the ground floor you will find an open planed, sun filled lounge/ dining room, along with an adjoining WC. To the first floor you will find two double bedrooms and one single along with main bathroom. Other benefits include a large private rear garden and close proximity to local primary and secondary schools, transport links, and shops including Iceland, David Lloyd gym as well as other local amenities. This property is available immediately so don't miss out call now to arrange a viewing.



£475,000

Greenford Road, Harrow HA1 3QF

GROUND FLOOR
379 sq.ft. (35.3 sq.m.) approx.

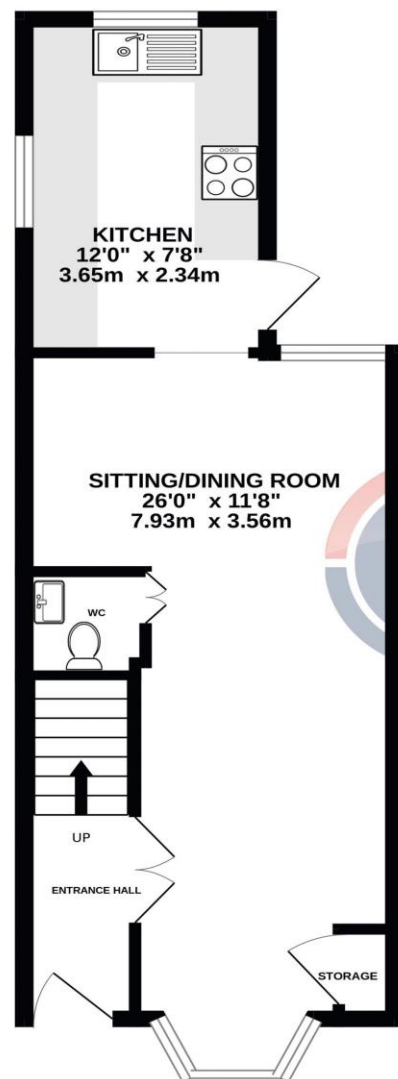

1ST FLOOR
371 sq.ft. (34.5 sq.m.) approx.

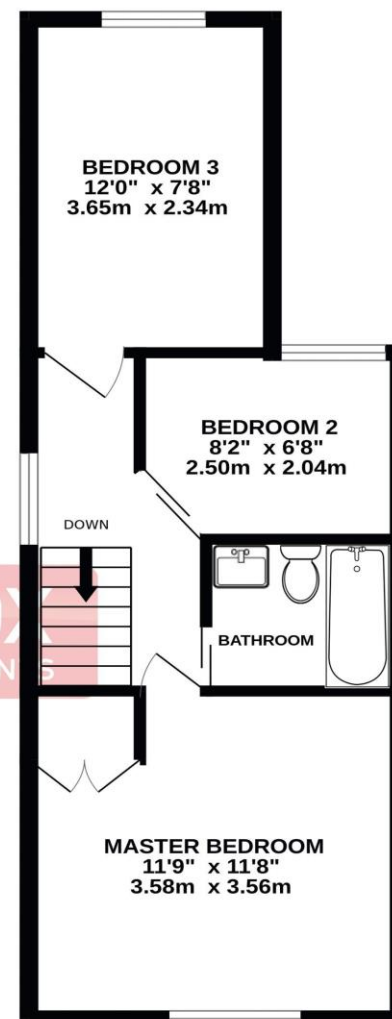

BRIAN COX
ESTATE AGENTS

TOTAL FLOOR AREA : 751 sq.ft. (69.7 sq.m.) approx.

Whilst every attempt has been made to ensure the accuracy of the floorplan contained here, measurements of doors, windows, rooms and any other items are approximate and no responsibility is taken for any error, omission or mis-statement. This plan is for illustrative purposes only and should be used as such by any prospective purchaser. The services, systems and appliances shown have not been tested and no guarantee as to their operability or efficiency can be given.
Made with Metropix ©2024

more details from...

call: **Brian Cox Harrow: 0208 912 0006**
email: **info@brian-cox.co.uk**
web: **www.brian-cox.co.uk**



Consumer Protection from Unfair Trading Regulations 2008 We have not tested any apparatus, equipment, fixtures, fittings or services and so cannot verify that they are in working order or fit for purpose. You are advised to obtain verification from your solicitor or surveyor. References to the tenure of a property are based on information supplied by the seller. We have not had sight of the title documents and a buyer is advised to obtain verification from their solicitor. Items shown in photographs are not included unless specifically mentioned within the sales particulars, but may be available by separate negotiation. We advise you to book an appointment to view before embarking on any journey to see a property, and check its availability.



in brief...

- 3 Bedrooms
- Ground Floor WC
- Gas Central Heating
- Large rear garden
- Close to Sudbury Hill Tube Station.
- Close to local amenities.



the location...

nearest stations ...

Sudbury Hill Harrow (0.1 miles) Sudbury Hill (0.0 miles) South Harrow (0.8 miles) Sudbury Hill is a suburb in the London Borough of Harrow, located in North West London, United Kingdom. There are many local schools in the area some of these include St George's Primary School, Wood End Academy, Greenwood Primary School and Horsenden Primary School. There are two stations in the area which are, Sudbury Hill Station (Piccadilly Line) and Sudbury Hill Harrow Station served by National Rail (Chiltern Railways). Frequent buses to Harrow, Wembley, Greenford and Ealing.