

the floorplan...

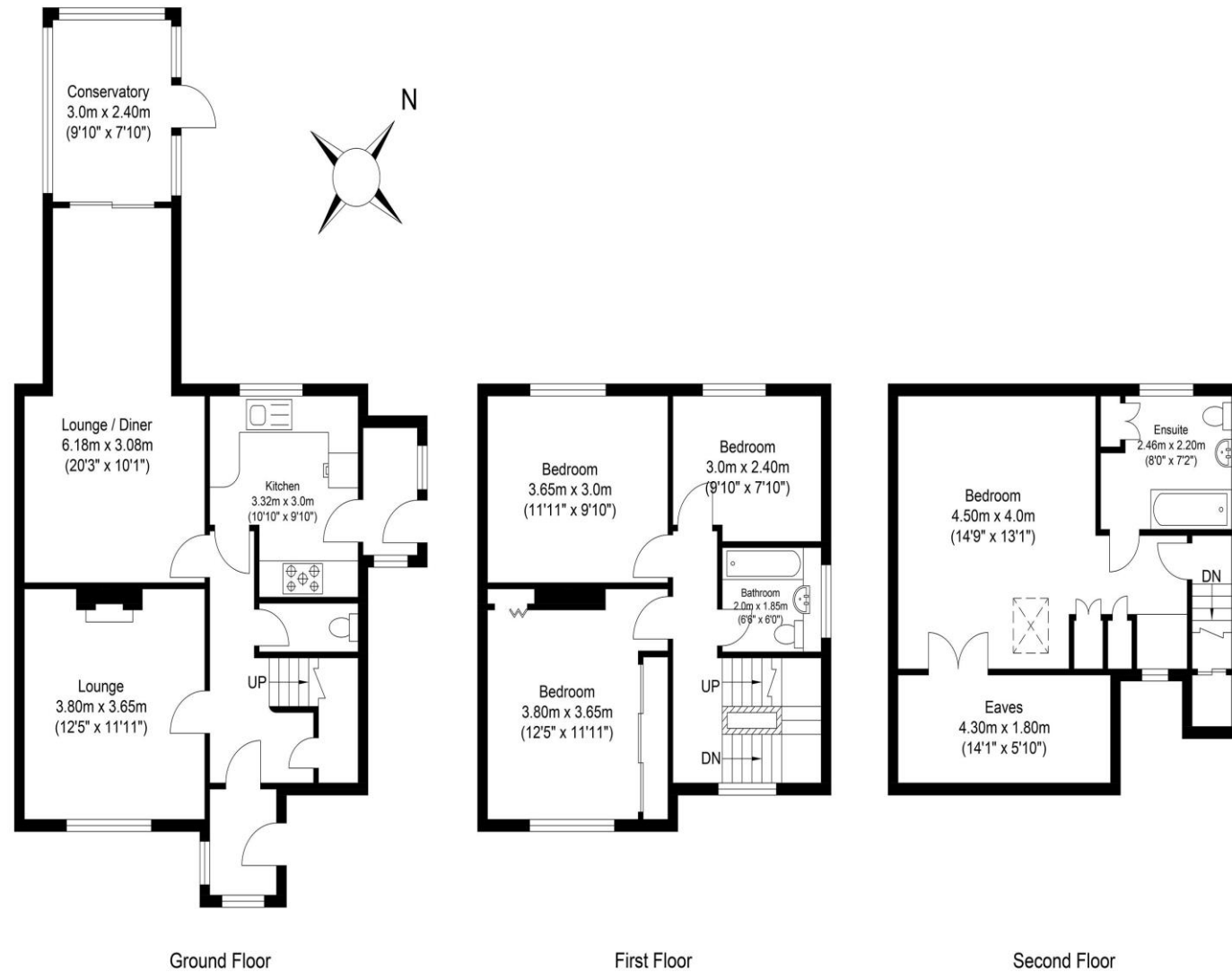

Approx Gross Internal Floor Area : 149.68 sq m. (1611.14 sq. ft.)
Garden Measurement - (15.70m x 9.30m = 51'6" x 30'6")



more details from...

call: **Brian Cox North Greenford: 0208 578 1004**
email: daniel.jed@brian-cox.co.uk
web: www.brian-cox.co.uk



0208 578 1004
brian-cox.co.uk



Brian Cox and Company are delighted to bring to the market this very well presented four bedroom semi-detached family home. This beautiful house has been painstaking extended and refurbished by the existing owners to offer light and spacious accommodation throughout as well as open well maintained external spaces. The property briefly consists of two reception rooms, a fully fitted kitchen, downstairs w/c, conservatory, family bathroom and four bedrooms including an ensuite to master. Viewings are highly recommended to fully appreciate all this remarkable home has to offer, so call now to arrange your opportunity to view!!



Offers in Excess of
£575,000

Melrose Close, Greenford UB6 9TD



in brief...

- Four Bedroom
- Semi-Detached House
- Master Bedroom with En-Suite
- Double Glazed / Gas Central Heating
- Fully Refurbished
- Potential to Extend (STPP)
- View Now



the location...

nearest stations ...

Greenford (0.8 miles)
Northolt (0.9 miles)
South Greenford (1.1 miles)

Greenford is a large suburb in the London Borough of Ealing in West London, UK. It was an ancient parish in the historic county of Middlesex. It is 11 miles (18 km) from Charing Cross in Central London.

The Northolt and Greenford Countryside Park (NGCP) links 110 hectares of open space in the North West of the borough. It is crossed by the A40 running from West to East into Central London and by the Grand Union Canal running from North to South. There are good walking and cycle routes throughout the park providing useful connections between sites.

There are several local schools in the area which include Coston Primary School, Edward Betham Church of England Primary School, Ravenor Primary School and Oldfield Primary School which all have a good or higher Ofsted report.