



Hillstead Court, Basingstoke, Hampshire, RG21 3PT

Guide Price £110,000



LODDON PROPERTIES is thrilled to present this beautifully maintained one-bedroom apartment in a sought-after over 55's development in the Fairfield's area. Recently refurbished, this property features an entrance hall, storage cupboard, a spacious lounge/diner with an attractive electric fireplace, a well-appointed kitchen, a double bedroom with fitted wardrobes, and a modern bathroom with a walk-in shower. Residents can enjoy access to a communal lounge and gardens. Situated in the highly desirable Fairfield's area, Hillstead Court offers convenient access to Basingstoke Town Centre, which is within walking distance. Basingstoke also provides a direct mainline railway service to London Waterloo in approximately 45 minutes. The town boasts an array of leisure facilities, including a sports center, cinema, theater, diverse dining options, and retail establishments such as the Festival Place shopping mall, John Lewis at Home, and Waitrose. Quick access to the M3 motorway (Junction 6) further enhances connectivity to London and the south coast. EPC details will be provided shortly. 01256808454 Contact one of the team to schedule your personal viewing Appointment! EPC Rating: C Council Tax Band: B 63 Years remaining on the lease. Service charges £2800 PA Ground rent £240 PA







- ONE DOUBLE BEDROOM APARTMENT
- OVER 55's DEVELOPMENT
- MODERN THROUGHOUT
- KITCHEN
- LOUNGE/DINER
- FITTED WARDROBES
- WALK IN SHOWER
- WALKING DISTANCE TO TOWN



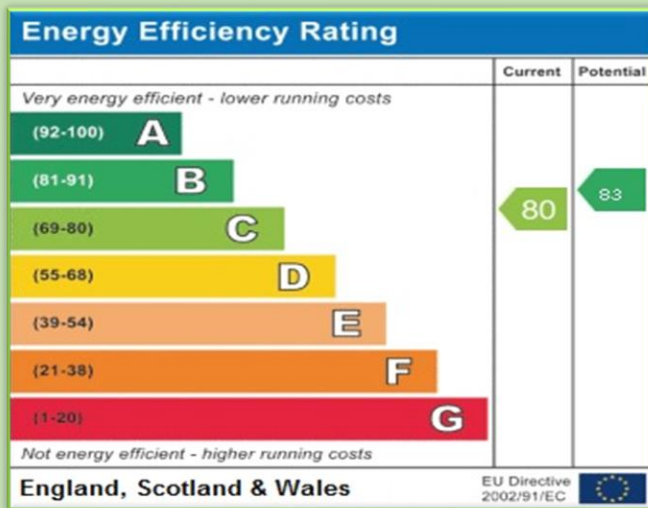

## Second Floor

Approx. 39.2 sq. metres (422.0 sq. feet)

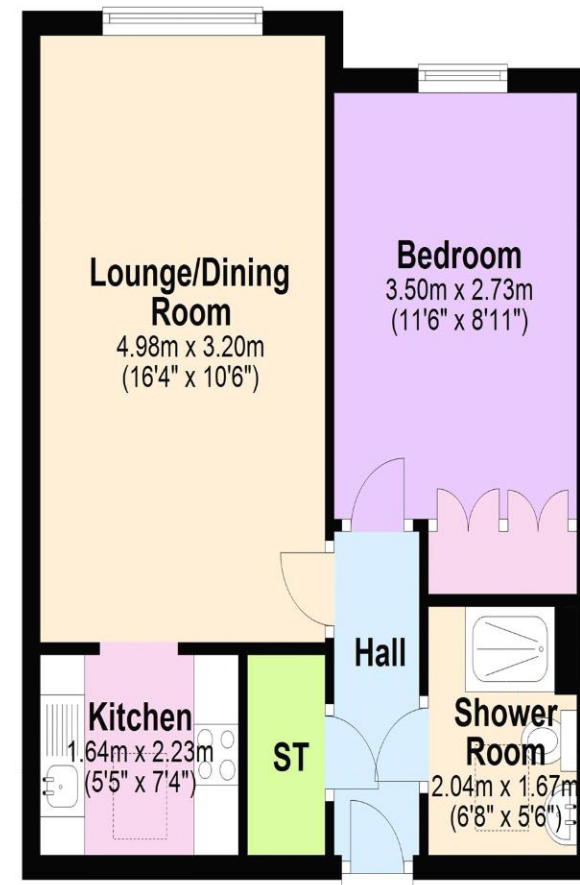

Total area: approx. 39.2 sq. metres (422.0 sq. feet)

All images used are for illustrative purposes only and are intended to convey the concept and vision for the property. They are provided as a guide only, and should be used as such. Floor plans are intended to give a general indication of the properties layout only. All images and dimensions are not intended to form part any contract or warranty.

Plan produced using PlanUp.

LODDON PROPERTIES

TEL: 01256 808 454

Chineham Shopping Centre Reading Road Chineham Basingstoke Hampshire  
RG24 8BQ  
info@loddonproperties.com  
www.loddonproperties.com